

## Solatube® Data Sheets

### SolaMaster® Series Material Specifications:

1. Dome is UV and impact resistant for extended service life. Its low profile design is unobtrusive. Impact modified, acrylic. Classified as CC2 material, .143" thick, with visible light transmission of 92% and ultra violet light transmission of .03%. (Optional polycarbonate domes available.)

2. LightTracker™ Reflector increases daylight collection and harvesting for low sun angles, resulting in increased light output. Spectralight® Infinity. For specifications see # 6 below.

3. Permeable Dome Seal locks out dust and bugs, but allows moisture to escape. Black breathable weatherstrip material with 0.40" pile.

4. Dome Ring and Dome Seal to channel condensed moisture out of the system. Durable white PVC, injection molded non-corrosive material.

5. One-Piece Seamless Flashing , 4"-, 8"- and 11"- high (100 mm/200 mm/280 mm) ensures a no-leak installation. 0.028 inches thick aluminized steel with powder coated exterior.

6. The 30-degree Angle Adaptors feature 30-degree elbows for easy installations. The diameter tubes fit between 24" (600 mm) on center framing. Angle adaptors utilize Spectralight® Infinity for a reflective surface.

**Spectralight® Infinity** material, fabricated from aluminum sheet meeting ASTM B 209 requirements, alloy and temper required by the manufacturer to suit forming operations and finish requirements, 0.018" thick.

**Interior Finish:** Spectralight Infinity high reflectance specular finish on exposed reflective surface; Visible spectrum (400 nm to 760 nm) greater than 99%; Total solar spectrum (400 nm to 2500 nm) less than 93%.

**Color:** a\* and b\* (defined by CIE L\*a\*b color model) shall not exceed plus 2 or be less than minus 2 as determined in accordance to ASTM E 308.

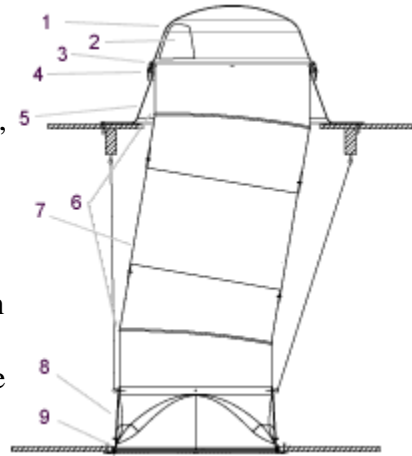

7. Extension Tubes are 24 in/600 mm in length, for installations up to 50 ft/15 m. Spectralight® Infinity.
8. 2'x 2' (600mm x 600mm) Transition Box (21 in/530 mm only). Fits a standard suspended ceiling system. Opaque polymeric material, classified as CC2, 0.060 in/1.5 mm thick.
9. Square Diffuser Panel fits into the transition box and complements traditional light fixtures. UV and weather resistant diffuser seal provides an effective dust and bug seal.

#### Brighten Up® Series Material Specifications:

1. Roof Dome: Injection molded, impact-resistant, acrylic with UV protective characteristics. Classified as CC2 material, .125" thick, with visible light transmission minimum 92%. Optional Shock Inner Dome for High Velocity Wind Zones. Raybender® 3000 Technology (Patented) Prismatic pattern molded into dome to capture low angle sunlight.

2. LightTracker™ Reflector increases daylight collection and harvesting for low sun angles, resulting in increased light output. Spectralight® Infinity. For specifications see # 5 below.

3. Dome Ring contains condensation gutter designed to channel out condensed moisture. Injection molded impact resistant acrylic.

4. Roof Flashing: Metal with protective powder coating complements roofing materials and combats corrosive material. Alternative Roof Flashing: CC2 long-lasting polypropylene, 30% mica-filled for added strength and durability.

5. Spectralight Infinity Tubing: Fabricated from aluminum sheet meeting the requirements of ASTM B 209, alloy and temper required by the manufacturer to suit forming operations and finish requirements, .015" thick.

**Interior Finish:** Spectralight Infinity high reflectance specular finish on exposed reflective surface; Visible spectrum (400 nm to 760 nm) greater than 99%; Total solar spectrum (400 nm to 2500 nm) less than 93%.

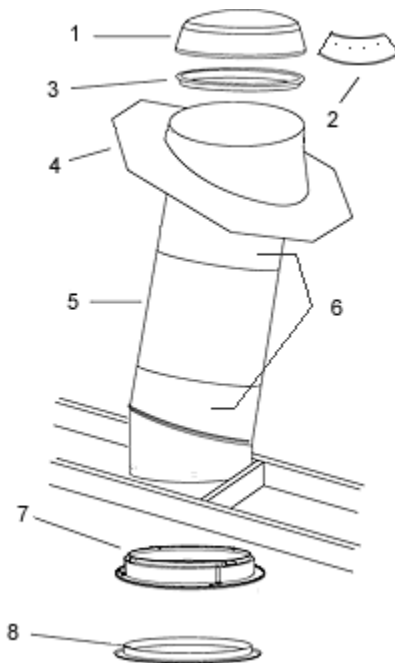

**Color:** a\* and b\* (defined by CIE L\*a\*b color model) shall not exceed plus 2 or be less than minus 2 as determined in accordance to ASTM E 308.

6. The 30 degree angle adaptors: Spectralight Infinity tubing fabricated from aluminum sheet meeting the requirements of ASTM B 209, alloy and temper required by the manufacturer to suit forming operations and finish requirements, .015" thick. Optional 0-90 Degree extension tube also available (.018" thick).

7. Ceiling Ring: Injected molded impact resistant acrylic.

8. Ceiling Diffuser Assembly (dual glazed): two options, OptiView® Diffuser or Vusion™ Diffuser.

a. Diffuser Lens:

**OptiView** – molded polycarbonate plastic classified as CC1 material.

**Vusion** – injection molded acrylic plastic classified as CC2 material.

b. Diffuser Dress Ring: Injection molded impact resistant acrylic.